

T.I. no.: 2021-223 Updated: -	Topic: Machine modification 03
---	---------------------------------------

Date: 26.08.2021	Priority	Need for action
Affected machines: SC Club	High	As soon as possible
From serial number:	X Medium	X On next visit to the machine
As of date: immediately	Low	FYI only

MASCHINEN MODIFICATION 03

This modification has meanwhile been implemented in the series and includes a change of the mounting position of the brewing valve and an adjustment of the maintenance kit.

The version 03 can be seen on the type plate of the machine - in the field "Ausf. 03".

Description of modification

Up to mod. 02, the brewing valve was part of the hot water valve block placed at the front of the cross head. The valve block in combination with the length of the feed hose coming from the hot water boiler could have a negative influence on the beverage dispensing temperatures.

With the target of increasing the beverage dispensing temperature (mainly for espresso) after a longer machine standby time, the mod. 03 described here was implemented.

With Mod. 03, the brewing valve is separated from the hot water valve block and now sits as a single valve directly above the hot water boiler. Due to the changed mounting position of the single brewing valve and the resulting shorter hose lengths, the beverage dispensing temperature could be increased by approx. 7K.

Due to the new single brewing valve, the maintenance concept and thus the maintenance kit (service maintenance 2 after 24 months) also had to be adapted; these changes are also listed here.

In order to introduce the Mod. 03 with less effort and as widespread as possible in the field, the Mod. 03 retrofit kit is temporarily enclosed with the new maintenance kit in order to retrofit machines with the new single brewing valve during regular machine maintenance.

A detailed retrofit instruction is enclosed with the retrofit kit Mod. 03.

Series and spare parts solution

With the following serial numbers the Mod. 03 has been introduced in series:

51643-51650	51688-51695	51698-51701	51703-51708	51734-51759
51763-51766	51768-51770	51807-51879	51884-51891	51896-51899
51975, ff.				

New Maintenance kit

33.4744.7000 – Maintenance kit SCClub 2.4kW - Mod.03

For spare parts supply see "further information and details".

Advice for Technicians

With the changed maintenance kit the machines need to be retrofitted - in the context of the next service maintenance - to Mod. 03. In order to do this, you should expect approx. 30 minutes extra effort per machine.

For further details and information, please refer to the following page and to the attached retrofit instruction.

FURTHER INFORMATION AND DETAILS

Spare parts supply

In case of repair, only complete valve blocks (without coils) could be ordered as spare parts from SCClub up to now. With the introduction of Mod. 03, this is now adapted to the logic of spare parts supply and thus changed as follows:

Steam valves

No.	Designation	Item number
1	1-line cappuccino valve (w/o coil) <ul style="list-style-type: none"> -> included in the new maintenance kit -> can be exchanged individually 	33.4233.2000
2	3-line steam valve block (w/o coil) <ul style="list-style-type: none"> The complete steam valve block can be exchanged Individual valves can be removed from the block and can be exchanged as single valves in case of repair 	33.4149.9000

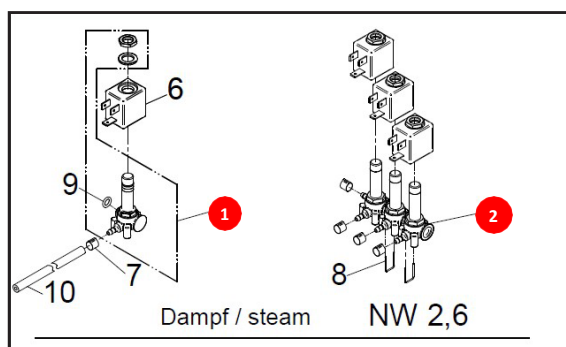

Hot water valves

No.	Designation	Item number
3	1-line brewing/connection valve (w/o coil) <ul style="list-style-type: none"> Included in the new maintenance kit Can be exchanged individually and can be used as brewing valve (Mod. 03) or as connection valve for valve block 	33.4399.9000
4	1-line intermediate/end valve (w/o coil) <ul style="list-style-type: none"> Can be exchanged individually can be used as intermediate or end valve for valve block. In case of use as intermediate valve the cover cap needs to be removed 	33.4415.6000
5	4-line valve block (w/o coil) <ul style="list-style-type: none"> The complete steam valve block can be exchanged. In case of use in machines as of Mod.03, the OLD brewing valve needs to be removed and the end valve needs to be closed with the cover cap of the previously removed brewing valve. Individual valves can be removed from the block and can be exchanged as single valves in case of repair 	33.4150.2000
6	1-line brewing vale OLD (up to Mod.02) <ul style="list-style-type: none"> Can be exchanged individually (for machines up to Mod. 02) 	33.4415.7000

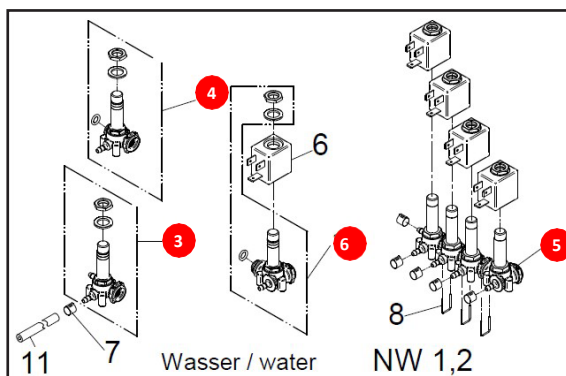

If a valve block is separated at a linkage, the O-ring enclosed with the spare part valve must be used for reconnection.

Maintenance kit

With the introduction of Mod. 03 the maintenance kit is adapted to the logic of the SCClub maintenance concept. The valve blocks from the kit are omitted and only the individual brewing and cappuccino valves are exchanged. The remaining maintenance parts and tasks remain unchanged.

The previous maintenance kit – 33.2937.9000 – is no longer available.

Temporary measure – retrofit kit Mod. 03

For the next 2 years, the retrofit kit Mod. 03 will be attached to the maintenance kit. Thus it is ensured that the machines in the field are retrofitted to Mod. 03 in the context of the next maintenance.