

<b>T.I. no.:</b> 2021-25 <b>Updated:</b> -	<b>Topic:</b> SCS / SOUL Software V4.30.9
---	---

<b>Date:</b> 27.09.2021	<b>Priority</b>	<b>Need for action</b>
<b>Affected machines:</b> SCS / SOUL	High	As soon as possible
<b>From serial number:</b> 2137..	X Medium	X On next visit to the machine
<b>As of date:</b> Immediately	Low	FYI only

## INFORMATION ON SOFTWARE UPDATE

The new software update V4.30.9 eliminates bugs, optimises the platform software and replaces the software version V4.26.7.

### Overview Features

- > SOUL: Brand logo replaceable in GUI (Media Package)
- > SOUL: Mobile Payment integrated (2nd Screen)
- > SOUL: Language selection configurable on GUI

### Overview Bugfix

- > SCS: Machine automatically stops descaling.

## INFORMATION

Further information can be found in the SCS/SOUL training documentation from Technical Support. This can be downloaded from the <Schaerer Coffee Link> portal in the Media Pool.



**Title:** Training modules / Reference manual

**Issue :** V13.0 | 09.2021

**Language:** deDE, enGB, zhCN and zhTW

<https://mediapool.coffeelinkng.schaerer.com/admin/share/7308c7c0>

## NEW FEATURES

### Brand logo replaceable in GUI (Media Package)

On the Frequent user or Guest mode of the SOUL the Schaerer logo is visible – per default – on the bottom-right corner. On Staff mode no logo can be displayed (the space is reserved).

Starting Software version 4.28 Schaerer’s brand logo may be replaced by another one (in this example, a Schaerer logo in black).



## SOUL: Mobile Payment integrated (2nd Screen)

A payment system has been integrated for beverage purchases via QR code as of this software release. If multiple payment options are available, the last selected payment method will be used by 2nd Screen.

## Language selection configuration

Enables max. 3 additional languageselections directly by the user on the user beverage selection screen. The languages can be freely defined and prioritised. By default, a standard flag is attached to each language but can be changed.

After beverage dispensing the machine reverts to the default language.

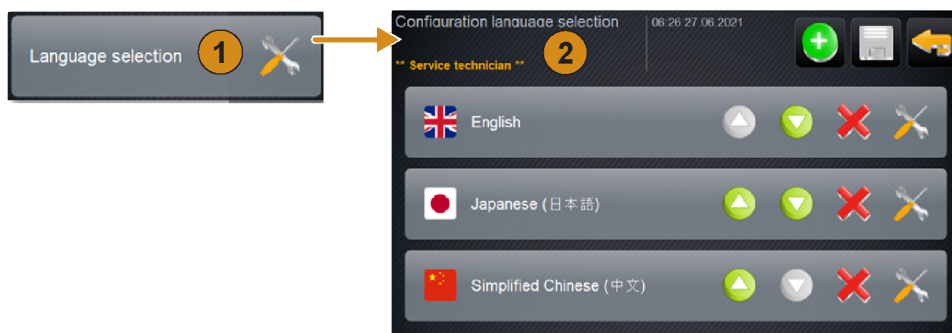

With the SOUL, the language for the Management UI can be configured separately from the Guest UI.

The language selection button in the Guest UI is only displayed if more than one language has been configured.

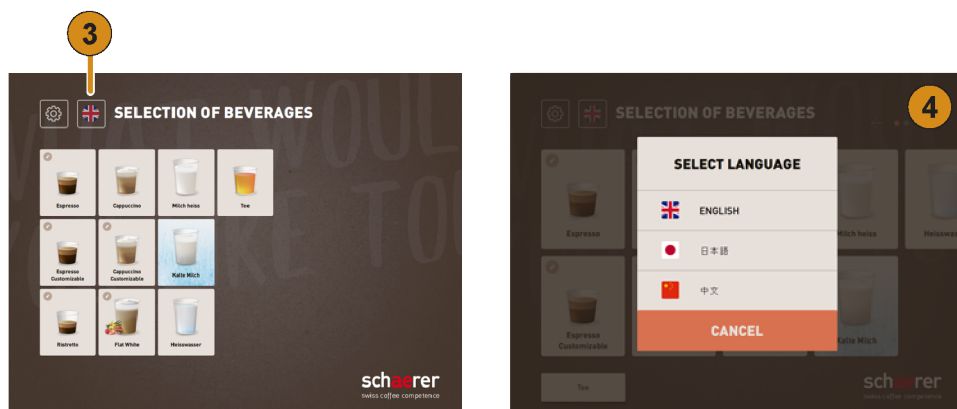

## OPTIMISATION

### Descaling process

With the following SCS machines that have a coffee and hot water boiler without a steam boiler, descaling is automatically interrupted during the cooling phase (progress indicator ~23%). The misbehaviour was analysed and the programme was adapted for the existing machine configuration.

**Note:** The software update must be carried out for the following machines. Decalcification is otherwise not possible.

- 2033634523
- 2046635108
- 2106635544
- 2111635640